

SOTTOPASSO CENTRALE

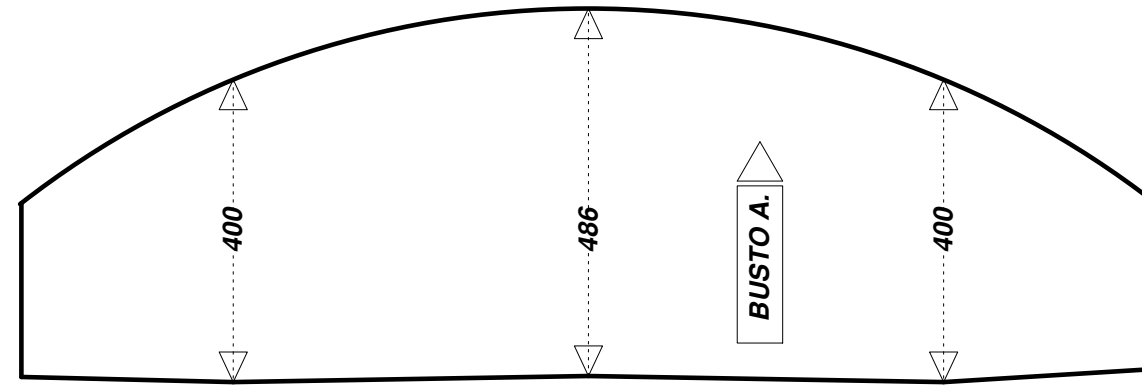

SOTTOPASSO VIA PER BUSTO - VIA 29 MAGGIO

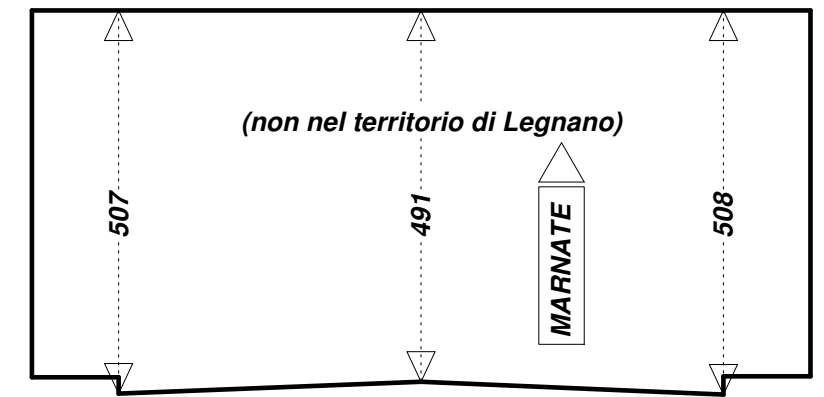

SOTTOPASSO VIA DELL'ACQUARELLA - FERROVIE NORD

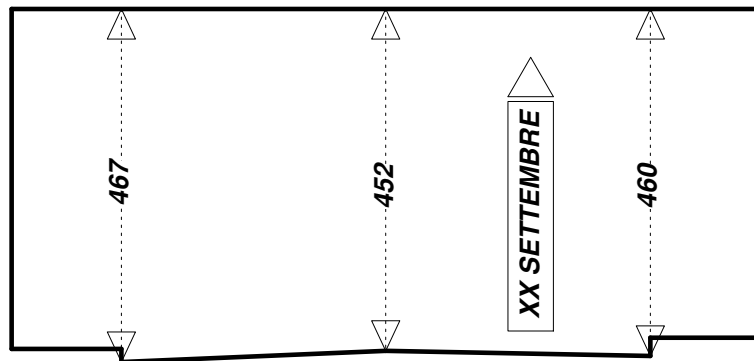

SOTTOPASSO SAN BERNARDINO- FRANCO TOSI

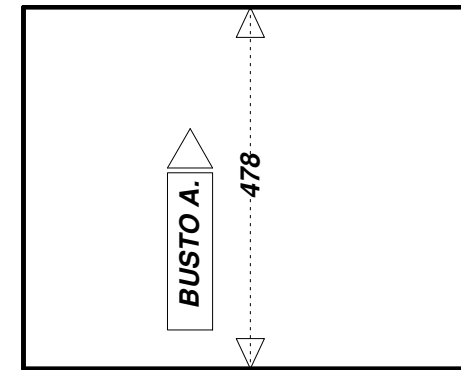
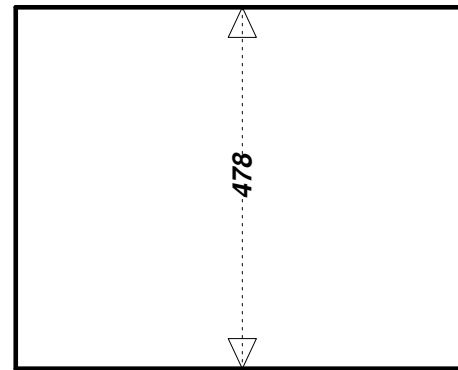

SOTTOPASSO VIA PER BUSTO - FERROVIE DELLO STATO

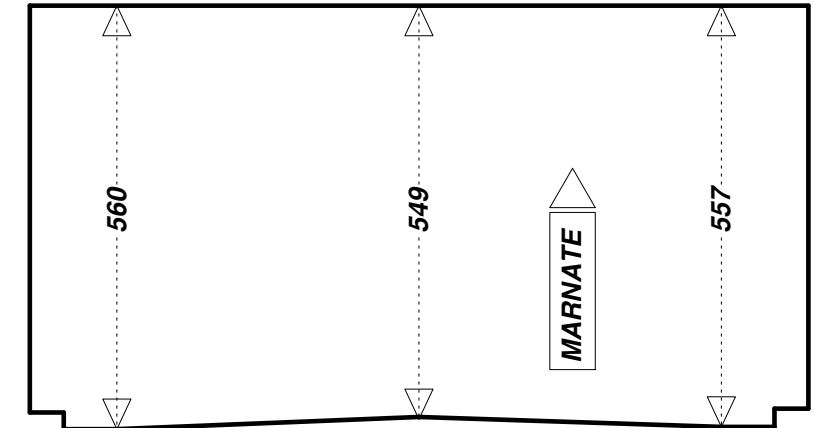

SOTTOPASSO 2 VIA DELL'ACQUARELLA

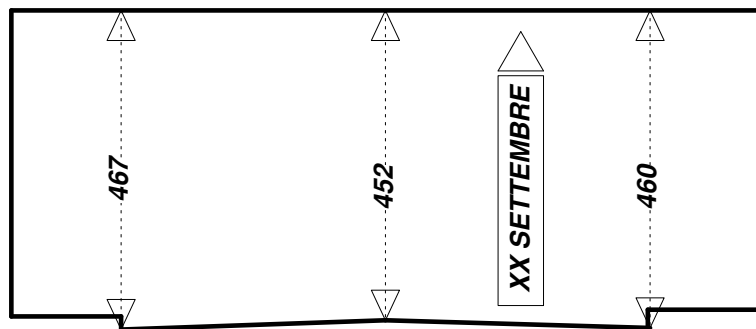

SOTTOPASSO SAN BERNARDINO- FERROVIE STATO

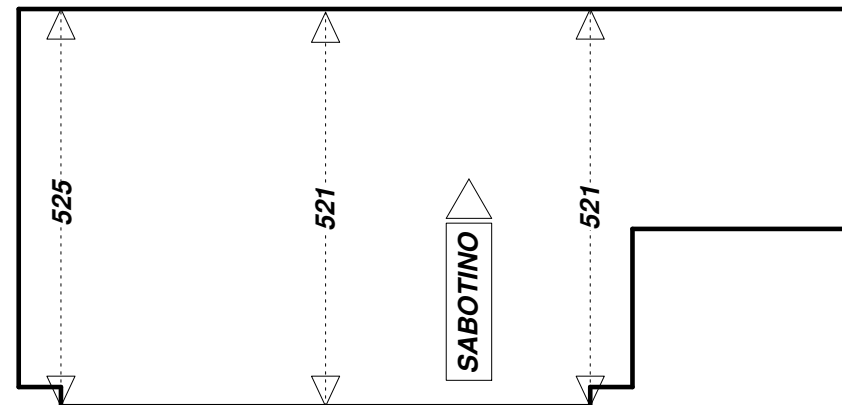

SOTTOPASSO DI VIA MONTEBELLO

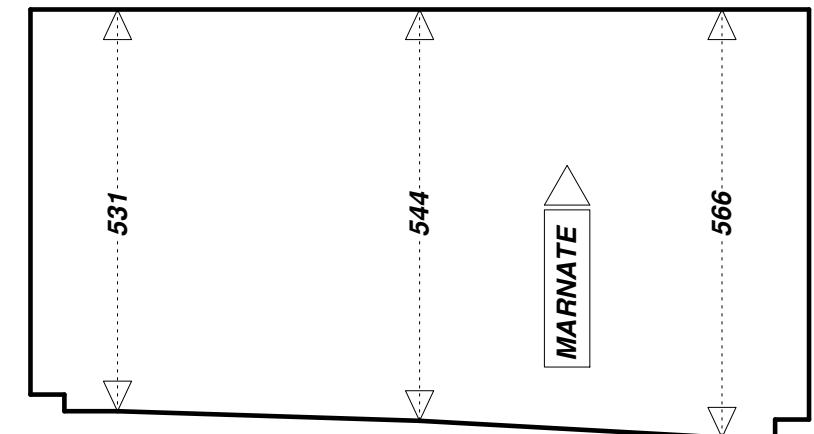

SOTTOPASSO 1 VIA DELL'ACQUARELLA

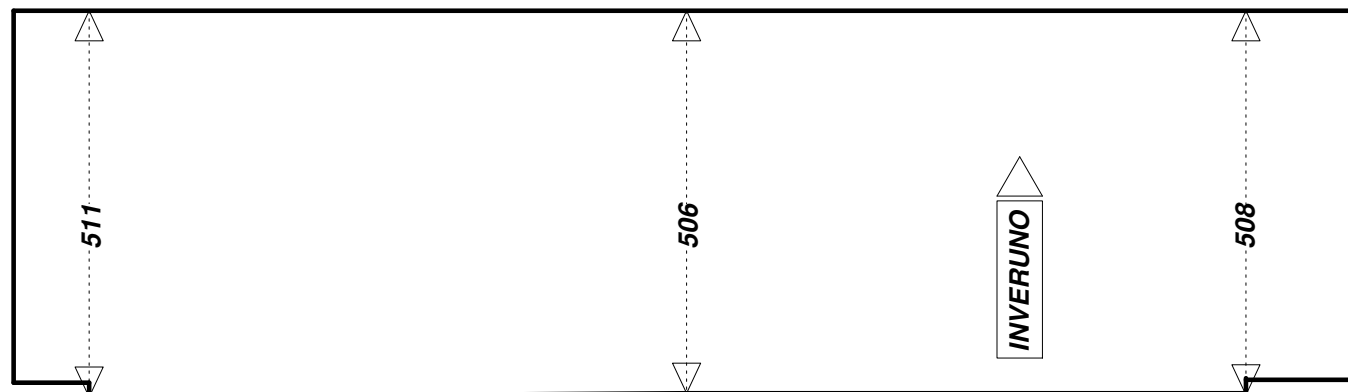

SOTTOPASSO VIA SAN MICHELE DEL CARSO

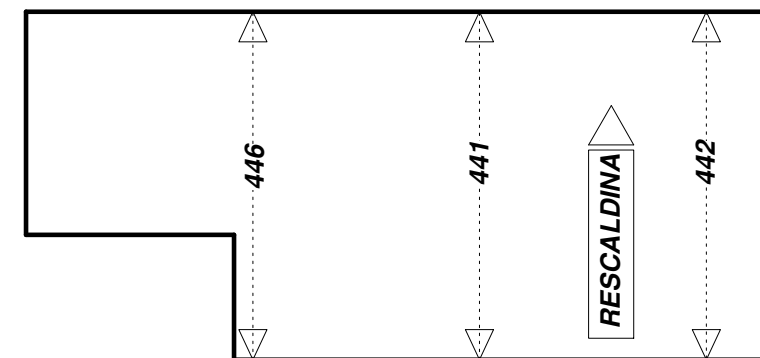

SOTTOPASSO VIA BARBARA MELZI - A8

**SETTORE OPERE PUBBLICHE
SERVIZIO STRADE FOGNATURE E VERDE PUBBLICO
UFFICIO STRADE**

SITUAZIONE AGGIORNATA AL 16 MAGGIO 2006

SCALA 1:100