

COMUNE DI LEGNANO

PROVINCIA DI MILANO

PIANO INTEGRATO di INTERVENTO

AREE IN VIA QUADRIO ANGOLO VIA ROSSINI
ANGOLO VIA DON MINZONI

IL PROGETTISTA

IL RESPONSABILE
DEL PROCEDIMENTO

L'ATTUATORE

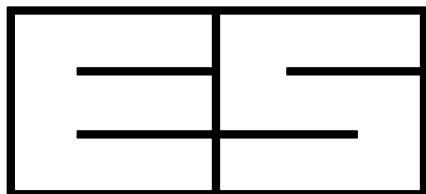

Dott. Ing. FUSETTI MARIO

LEGNANO VIA ALFIERI n° 50
TEL 0331/597767
e-mail: info@studiofusetti.it

COMMITTENTE

Immobilombarda S.r.l.

PROGETTO

AREA IN LEGNANO
Via QUADRIO

OGGETTO

CALCOLO SLP

TAVOLA

8V

PRATICA

SCALA

1: 200

DATA Gennaio 2019

AGGIORNATO settembre 2019

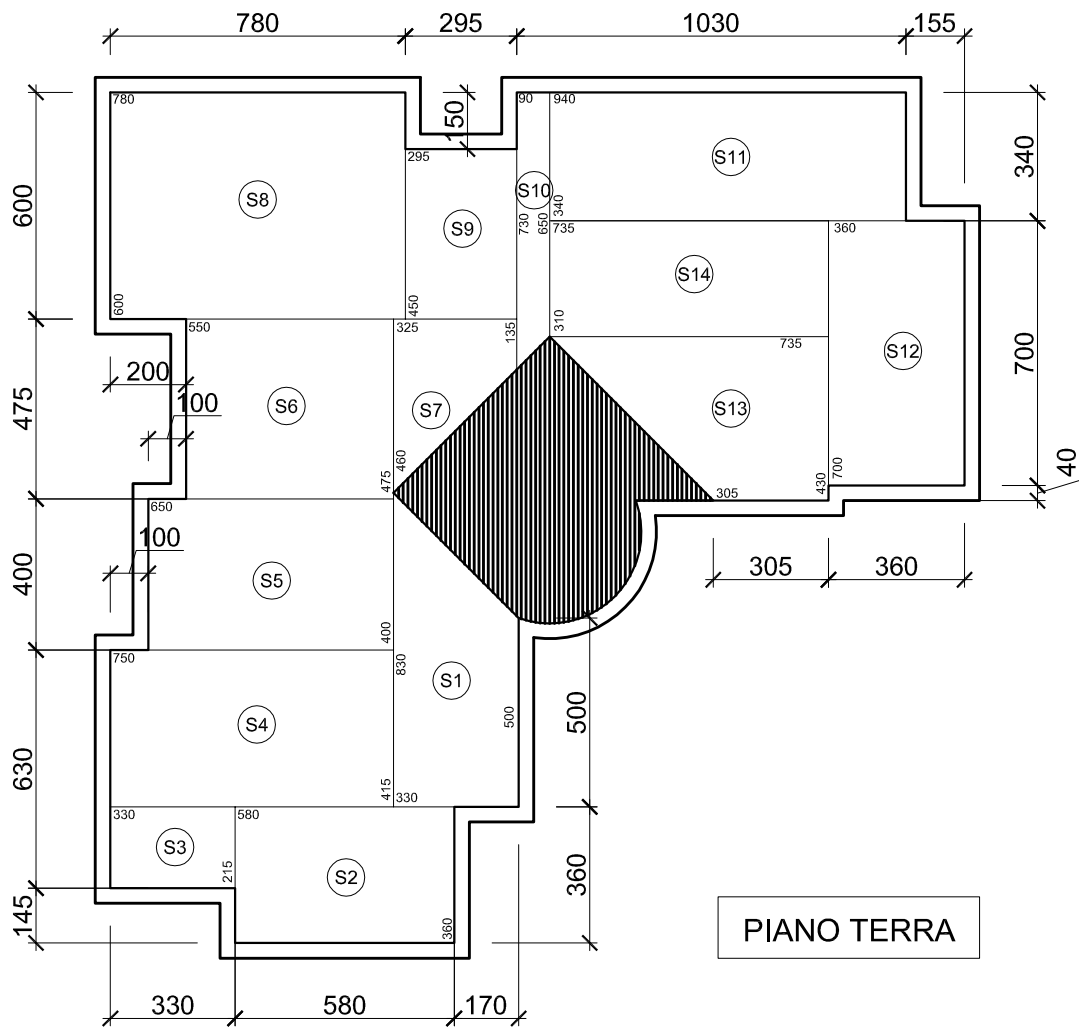

PIANO TERRA

⊙ S1	$8.30+5.00/2 \times 3.30 =$	21.94 MQ
⊙ S2	$5.80+3.60 =$	20.88 MQ
⊙ S3	$3.30+2.15 =$	7.09 MQ
⊙ S4	$7.50 \times 4.15 =$	31.12 MQ
⊙ S5	$6.50 \times 4.00 =$	26.00 MQ
⊙ S6	$5.50 \times 4.75 =$	26.12 MQ
⊙ S7	$4.60+1.35/2 \times 3.25 =$	9.66 MQ
⊙ S8	$7.80 \times 6.00 =$	46.80 MQ
⊙ S9	$4.50 \times 2.95 =$	13.26 MQ
⊙ S10	$7.30+6.50/2 \times 0.90 =$	6.21 MQ
⊙ S11	$9.40 \times 3.40 =$	31.96 MQ
⊙ S12	$7.00 \times 3.60 =$	25.20 MQ
⊙ S13	$7.35+3.05/2 \times 4.30 =$	22.36 MQ
⊙ S14	$7.35 \times 3.10 =$	22.78 MQ
	SLP TOTALE	<u>311.38 MQ</u>

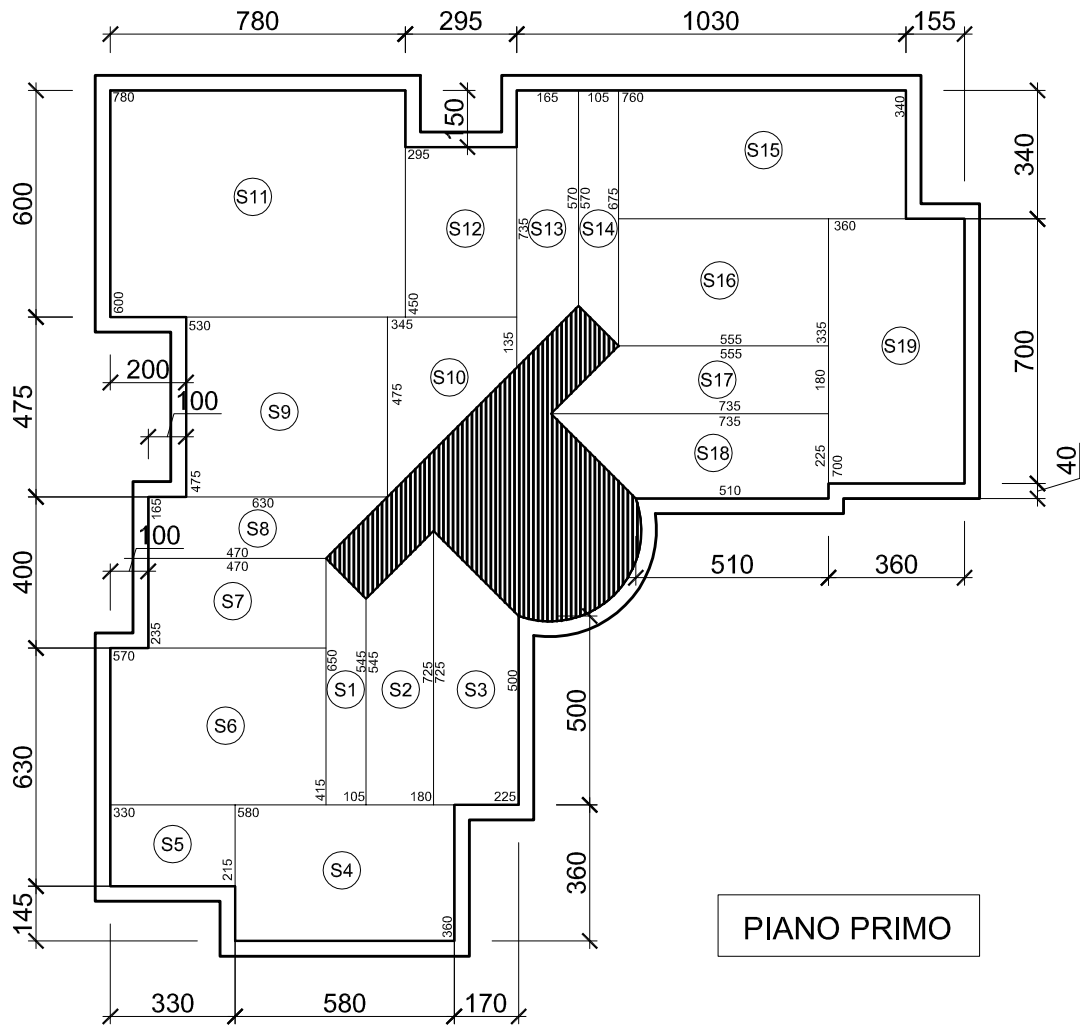

Ⓢ1	$6.50+5.45/2 \times 1.05 =$	6.27 MQ
Ⓢ2	$7.25+5.45/2 \times 1.80 =$	11.43 MQ
Ⓢ3	$7.25+5.00/2 \times 2.25 =$	13.78 MQ
Ⓢ4	$5.80 \times 3.60 =$	20.88 MQ
Ⓢ5	$3.30 \times 2.15 =$	7.09 MQ
Ⓢ6	$5.70 \times 4.15 =$	23.66 MQ
Ⓢ7	$4.70 \times 2.35 =$	11.04 MQ
Ⓢ8	$6.30+4.70/2 \times 1.65 =$	9.08 MQ
Ⓢ9	$5.30 \times 4.75 =$	25.17 MQ
Ⓢ10	$4.75+1.35/2 \times 3.45 =$	10.52 MQ
Ⓢ11	$6.00 \times 7.80 =$	46.80 MQ
Ⓢ12	$4.50 \times 2.95 =$	13.28 MQ
Ⓢ13	$7.35+5.70/2 \times 1.65 =$	10.76 MQ
Ⓢ14	$6.75+5.70/2 \times 1.05 =$	6.53 MQ
Ⓢ15	$7.60 \times 3.40 =$	25.84 MQ
Ⓢ16	$5.55 \times 3.35 =$	18.59 MQ
Ⓢ17	$7.35+5.55/2 \times 1.80 =$	11.61 MQ
Ⓢ18	$7.35+5.10/2 \times 2.25 =$	14.00 MQ
Ⓢ19	$7.00 \times 3.60 =$	25.20 MQ
SLP TOTALE		<u>311.53 MQ</u>

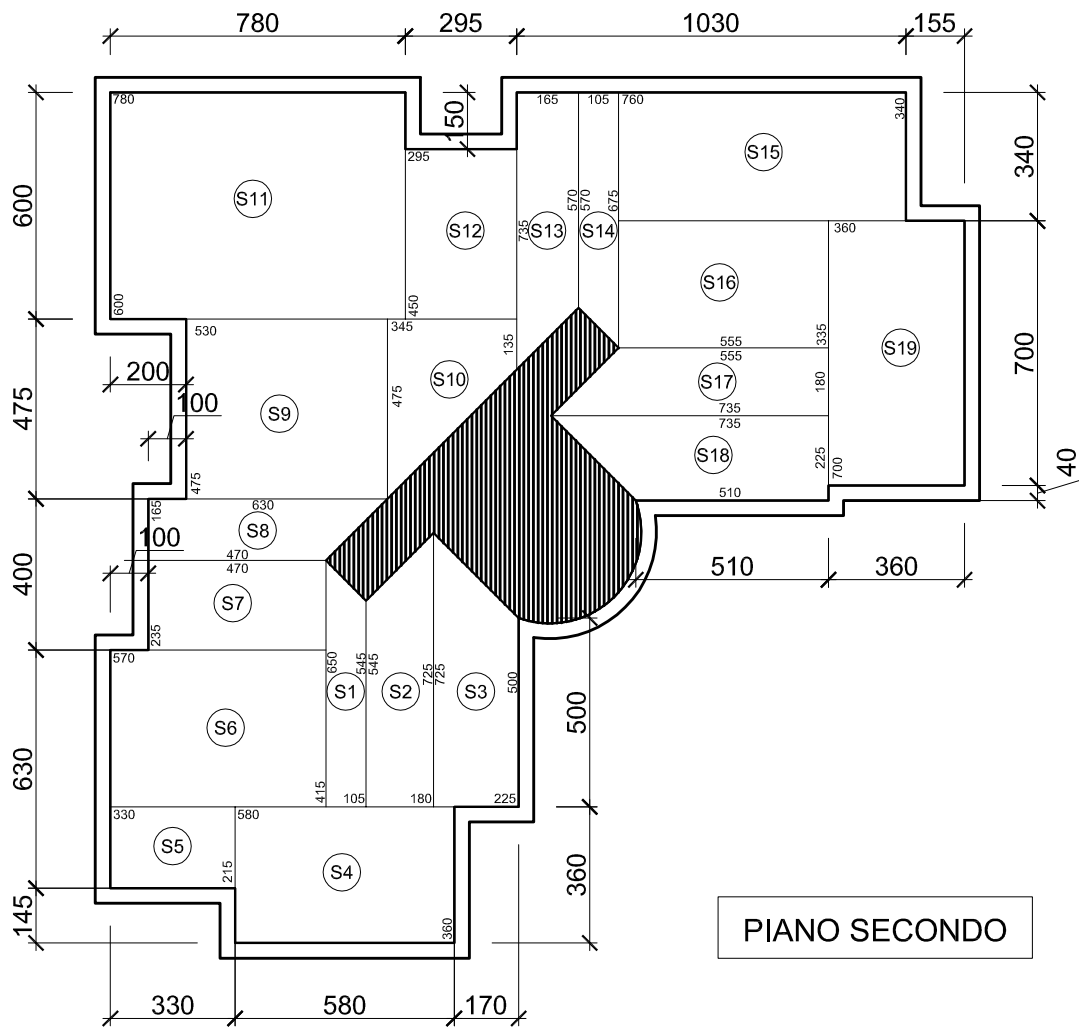

PIANO SECONDO

⊙ S1	$6.50+5.45/2 \times 1.05 =$	6.27 MQ
⊙ S2	$7.25+5.45/2 \times 1.80 =$	11.43 MQ
⊙ S3	$7.25+5.00/2 \times 2.25 =$	13.78 MQ
⊙ S4	$5.80 \times 3.60 =$	20.88 MQ
⊙ S5	$3.30 \times 2.15 =$	7.09 MQ
⊙ S6	$5.70 \times 4.15 =$	23.66 MQ
⊙ S7	$4.70 \times 2.35 =$	11.04 MQ
⊙ S8	$6.30+4.70/2 \times 1.65 =$	9.08 MQ
⊙ S9	$5.30 \times 4.75 =$	25.17 MQ
⊙ S10	$4.75+1.35/2 \times 3.45 =$	10.52 MQ
⊙ S11	$6.00 \times 7.80 =$	46.80 MQ
⊙ S12	$4.50 \times 2.95 =$	13.28 MQ
⊙ S13	$7.35+5.70/2 \times 1.65 =$	10.76 MQ
⊙ S14	$6.75+5.70/2 \times 1.05 =$	6.53 MQ
⊙ S15	$7.60 \times 3.40 =$	25.84 MQ
⊙ S16	$5.55 \times 3.35 =$	18.59 MQ
⊙ S17	$7.35+5.55/2 \times 1.80 =$	11.61 MQ
⊙ S18	$7.35+5.10/2 \times 2.25 =$	14.00 MQ
⊙ S19	$7.00 \times 3.60 =$	25.20 MQ
	SLP TOTALE	<u>311.53 MQ</u>

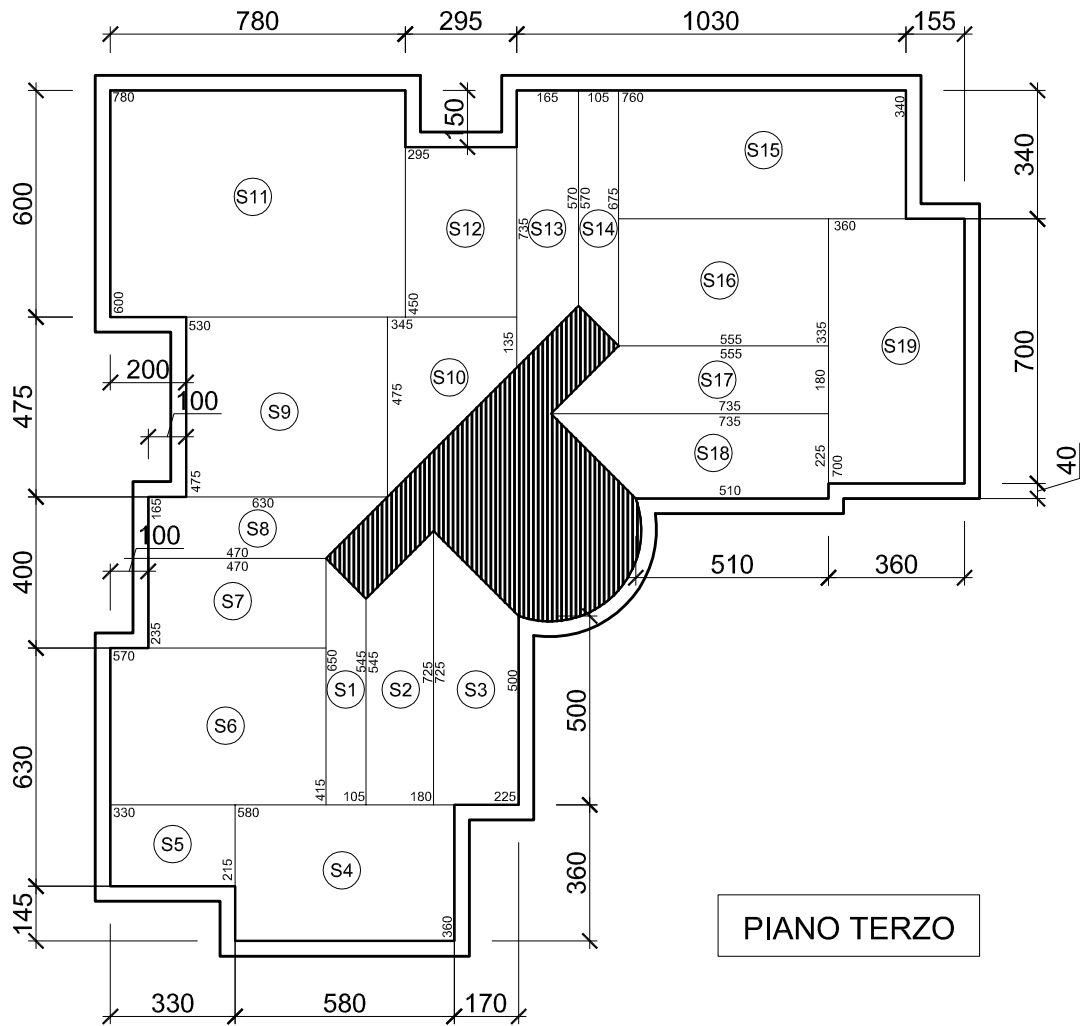

PIANO TERZO

⊙ S1	$6.50+5.45/2 \times 1.05 =$	6.27 MQ
⊙ S2	$7.25+5.45/2 \times 1.80 =$	11.43 MQ
⊙ S3	$7.25+5.00/2 \times 2.25 =$	13.78 MQ
⊙ S4	$5.80 \times 3.60 =$	20.88 MQ
⊙ S5	$3.30 \times 2.15 =$	7.09 MQ
⊙ S6	$5.70 \times 4.15 =$	23.66 MQ
⊙ S7	$4.70 \times 2.35 =$	11.04 MQ
⊙ S8	$6.30+4.70/2 \times 1.65 =$	9.08 MQ
⊙ S9	$5.30 \times 4.75 =$	25.17 MQ
⊙ S10	$4.75+1.35/2 \times 3.45 =$	10.52 MQ
⊙ S11	$6.00 \times 7.80 =$	46.80 MQ
⊙ S12	$4.50 \times 2.95 =$	13.28 MQ
⊙ S13	$7.35+5.70/2 \times 1.65 =$	10.76 MQ
⊙ S14	$6.75+5.70/2 \times 1.05 =$	6.53 MQ
⊙ S15	$7.60 \times 3.40 =$	25.84 MQ
⊙ S16	$5.55 \times 3.35 =$	18.59 MQ
⊙ S17	$7.35+5.55/2 \times 1.80 =$	11.61 MQ
⊙ S18	$7.35+5.10/2 \times 2.25 =$	14.00 MQ
⊙ S19	$7.00 \times 3.60 =$	25.20 MQ
	SLP TOTALE	<u>311.53 MQ</u>

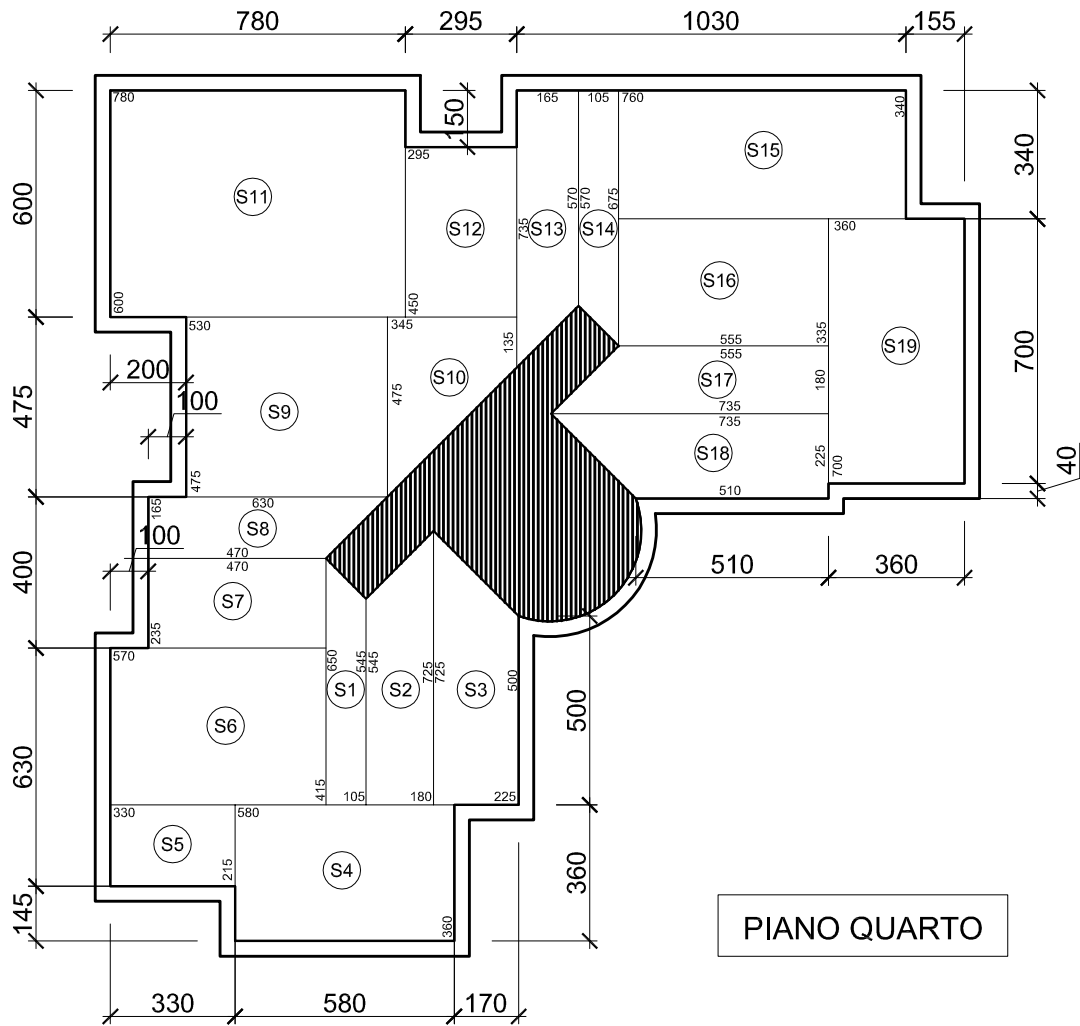

PIANO QUARTO

⊙ S1	$6.50+5.45/2 \times 1.05 =$	6.27 MQ
⊙ S2	$7.25+5.45/2 \times 1.80 =$	11.43 MQ
⊙ S3	$7.25+5.00/2 \times 2.25 =$	13.78 MQ
⊙ S4	$5.80 \times 3.60 =$	20.88 MQ
⊙ S5	$3.30 \times 2.15 =$	7.09 MQ
⊙ S6	$5.70 \times 4.15 =$	23.66 MQ
⊙ S7	$4.70 \times 2.35 =$	11.04 MQ
⊙ S8	$6.30+4.70/2 \times 1.65 =$	9.08 MQ
⊙ S9	$5.30 \times 4.75 =$	25.17 MQ
⊙ S10	$4.75+1.35/2 \times 3.45 =$	10.52 MQ
⊙ S11	$6.00 \times 7.80 =$	46.80 MQ
⊙ S12	$4.50 \times 2.95 =$	13.28 MQ
⊙ S13	$7.35+5.70/2 \times 1.65 =$	10.76 MQ
⊙ S14	$6.75+5.70/2 \times 1.05 =$	6.53 MQ
⊙ S15	$7.60 \times 3.40 =$	25.84 MQ
⊙ S16	$5.55 \times 3.35 =$	18.59 MQ
⊙ S17	$7.35+5.55/2 \times 1.80 =$	11.61 MQ
⊙ S18	$7.35+5.10/2 \times 2.25 =$	14.00 MQ
⊙ S19	$7.00 \times 3.60 =$	25.20 MQ
	SLP TOTALE	<u>311.53 MQ</u>